

# UNCONTROLLED

REVISIONS			
SYS	DESCRIPTION	DATE	APPROV
B	PER ECN 1168 & 1252	10/23/14	

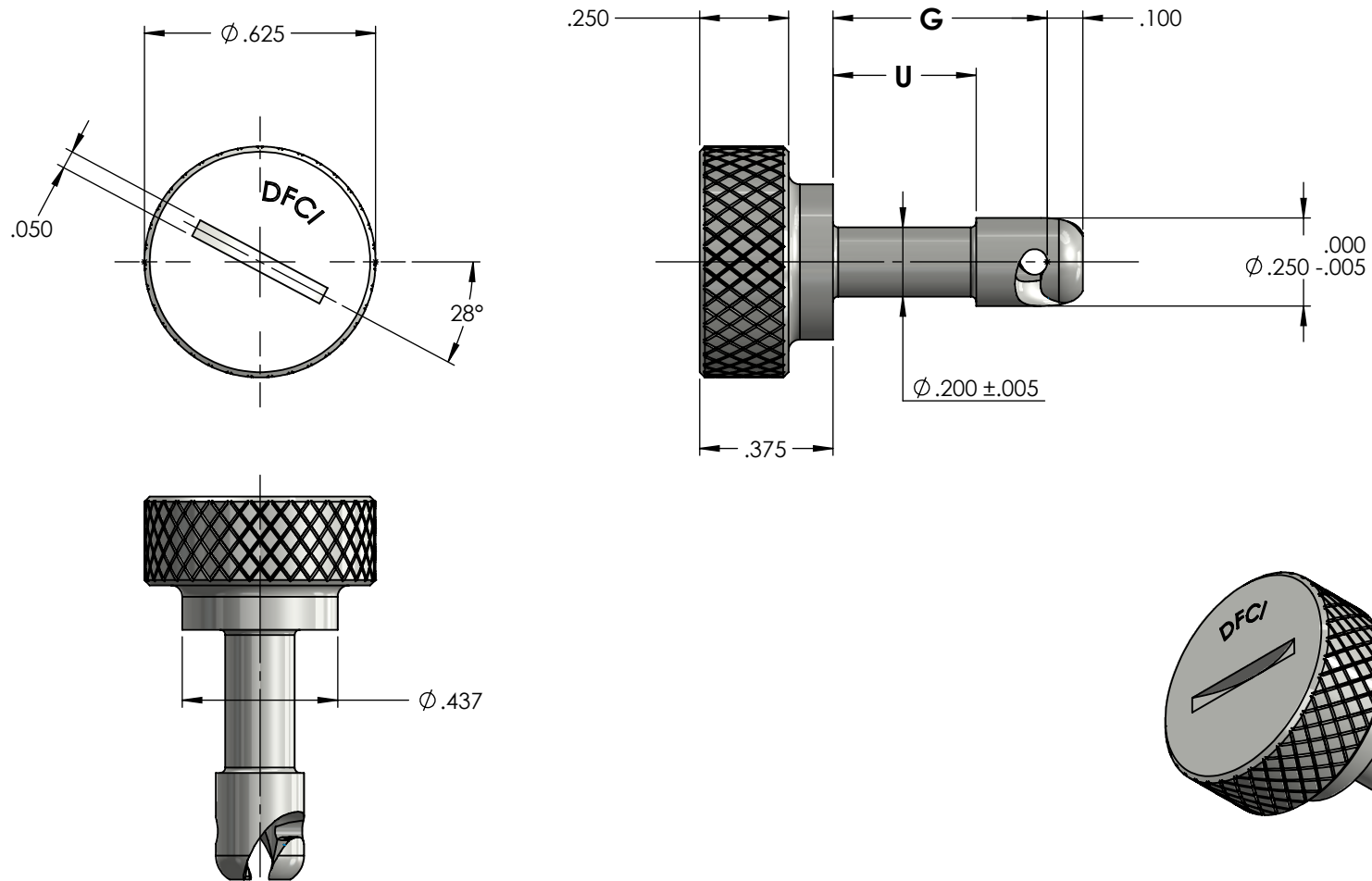

MATERIAL:	A.I.S.I. 8620 STEEL OR TYPE 303 STAINLESS STEEL
HEAT TREAT:	SEE NOTE 4
FINISH:	SEE NOTE 1
<small>THE FASTENER PARTS SHOWN IN THIS PRINT ARE PROPRIETARY ARTICLES TO WHICH DFCI SOLUTIONS INC., RETAINS THE EXCLUSIVE RIGHTS OF MANUFACTURE, USE AND SALE. THE PRINT OR DRAWING IS SUBMITTED IN CONFIDENCE AND DOES NOT CONVEY A LICENSE OR PERMISSION TO MANUFACTURE THE FASTENER OR FASTENER PARTS.</small>	
<small>(C) COPYRIGHT 2009, DFCI SOLUTIONS INC. ALL RIGHTS RESERVED.</small>	

TOLERANCES ON DIMENSIONS UNLESS OTHERWISE SPECIFIED	
X* = ±2°	.XX = ±.015
X/X = ±1/32	.XXX = ±.010
MACHINE FINISH = .125	
PART NO.	SEE TABLE ON SHEET 2 OF 2
DRN	Frank Basile DATE 10/23/14
CHK.	Frank Basile DATE 10/23/14
ENG.	[Signature] DATE 10/23/14
MFG.	Rashid Zubair DATE 10/23/14
Q.C.	[Signature] DATE 10/23/14
SALES.	DATE
NEXT ASSY	USED ON
APPLICATION BLOCK	

**DFCI SOLUTIONS INC.**  
425 UNION BOULEVARD.  
WEST ISLIP, NEW YORK 11795

TITLE		ST-1200 KNURLED HEAD STUD 1211-4**-Z3CT	
SIZE	FSCM NO.	DWG. NO.	REV.
A	72794	C1211-4	B
SCALE: NTS		WEIGHT:	SHEET 1 OF 2

# UNCONTROLLED

REVISIONS			
SYS	DESCRIPTION	DATE	APPROV
B	PER ECN 1168 & 1252	10/23/14	

PART NUMBER	G DIMENSION	U DIMENSION
1211-425-Z3CT	.250	.100
1211-430-Z3CT	.300	
1211-435-Z3CT	.350	.150
1211-440-Z3CT	.400	.200
1211-445-Z3CT	.450	.225
1211-450-Z3CT	.500	.250
1211-455-Z3CT	.550	.275
1211-460-Z3CT	.600	.300
1211-465-Z3CT	.650	.350
1211-470-Z3CT	.700	
1211-475-Z3CT	.750	.400
1211-480-Z3CT	.800	
1211-485-Z3CT	.850	.500
1211-490-Z3CT	.900	
1211-495-Z3CT	.950	.600
1211-4100-Z3CT	1.000	
1211-4110-Z3CT	1.100	
1211-4120-Z3CT	1.200	
1211-4130-Z3CT	1.300	
1211-4140-Z3CT	1.400	
1211-4150-Z3CT	1.500	

**NOTES:**

1. FINISH:  
ZINC PLATE PER ASTM-B-633, TYPE III, SC2, CLEAR TRIVALENT CHROMATE WITH SEALER. (RoHS COMPLIANT FINISH)
2. FOR THE APPLICATION OF ALTERNATIVE FINISHES, REMOVE THE SUFFIX -Z3CT FROM THE PART NUMBER AND ADD THE REQUIRED FINISH SUFFIX TO THE PART NUMBER. EXAMPLE: FOR ZINC YELLOW TRIVALENT CHROMATE THE PART NUMBER WOULD BE 1211-430-Z3YT
3. PLEASE VISIT [www.dfcis.com/c1211-4](http://www.dfcis.com/c1211-4) FOR A LIST OF AVAILABLE FINISHES.
4. HEAT TREATMENT:  
STEEL STUD - ROCKWELL C27 - 33  
STAINLESS STEEL STUD IS NOT HEAT TREATED
5. THE PART NUMBER FOR A STUD MADE FROM TYPE 303 STAINLESSS STEEL, REMOVE THE SUFFIX -Z3CT AND ADD -SS TO THE PART NUMBER. EXAMPLE: 1211-430-SS



MATERIAL: A.I.S.I. 8620 STEEL OR TYPE 303 STAINLESS STEEL

TOLERANCES ON DIMENSIONS UNLESS OTHERWISE SPECIFIED

X\* = ±2° .XX = ±.015  
X/X = ±1/32 .XXX = ±.010 MACHINE FINISH = .125

HEAT TREAT: SEE NOTE 4

PART NO. SEE TABLE DRN *Frank Basile* DATE 10/23/14

FINISH: SEE NOTE 1

CHK. *Frank Basile* DATE 10/23/14

THE FASTENER PARTS SHOWN IN THIS PRINT ARE PROPRIETARY ARTICLES TO WHICH DFCI SOLUTIONS INC., RETAINS THE EXCLUSIVE RIGHTS OF MANUFACTURE, USE AND SALE. THE PRINT OR DRAWING IS SUBMITTED IN CONFIDENCE AND DOES NOT CONVEY A LICENSE OR PERMISSION TO MANUFACTURE THE FASTENER OR FASTENER PARTS.

ENG. *Peter Albrand* DATE 10/23/14

(C) COPYRIGHT 2009, DFCI SOLUTIONS INC. ALL RIGHTS RESERVED.

MFG. *Rashad Lubman* DATE 10/23/14

Q.C. *Peter Albrand* DATE 10/23/14

SALES. DATE



**DFCI SOLUTIONS INC.**

425 UNION BOULEVARD.  
WEST ISLIP, NEW YORK 11795

TITLE: ST-1200 KNURLED HEAD STUD  
1211-4\*\*-Z3CT

SIZE **A** FSCM NO. 72794 DWG. NO. C1211-4 REV. B

SCALE: NTS WEIGHT: SHEET 2 OF 2