

UNCONTROLLED

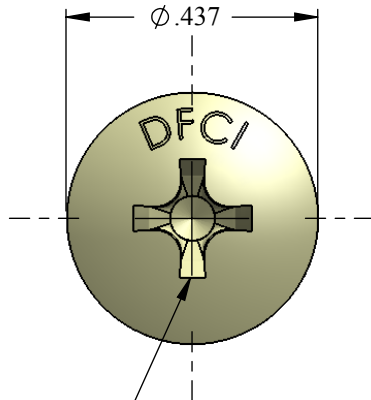

#2 PHILLIPS RECESS,
.124 MAX. DEPTH
FLOW OUT ON ALL FOUR
ENDS PERMISSIBLE

.100 max.

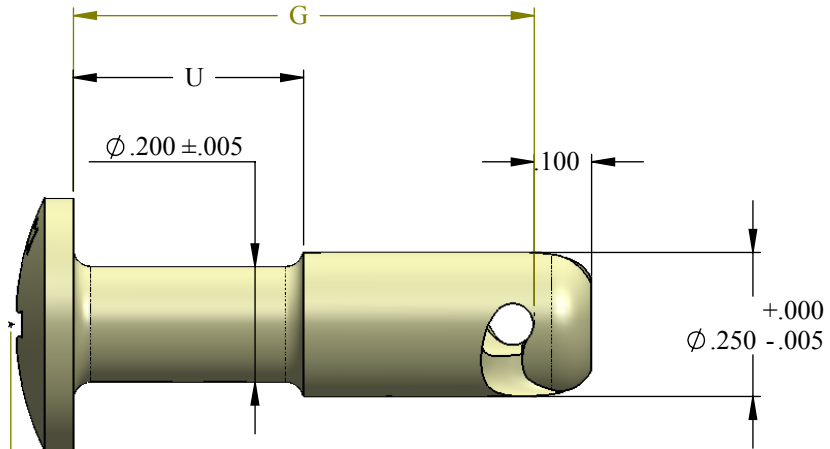

REVISIONS			
SYS	DESCRIPTION	DATE	APPROV
D	PER ECN 1168	01/15/10	F.B.

FOR STUD PART NO. REFER TO SHEET 2 OF 2

MATERIAL:	PER A.I.S.I 10B21, 8620 STEEL OR TYPE 303 ST. STEEL
HEAT TREAT:	PER NOTE 2
FINISH:	PER NOTE 1
<small>THE FASTENER PARTS SHOWN IN THIS PRINT ARE PROPRIETARY ARTICLES TO WHICH DFCI SOLUTIONS INC., RETAINS THE EXCLUSIVE RIGHTS OF MANUFACTURE, USE AND SALE. THE PRINT OR DRAWING IS SUBMITTED IN CONFIDENCE AND DOES NOT CONVEY A LICENSE OR PERMISSION TO MANUFACTURE THE FASTENER OR FASTENER PARTS.</small>	
<small>(C) COPYRIGHT 2009, DFCI SOLUTIONS INC. ALL RIGHTS RESERVED.</small>	

TOLERANCES ON DIMENSIONS UNLESS OTHERWISE SPECIFIED			
X* = ±2°	.XX = ±.015	MACHINE FINISH = .125	
X/X = ±1/32	.XXX = ±.010		
PART NO.	SEE PAGE 2 OF 2	DRN	W. Zhindon
		DATE	01/13/10
		CHK.	F Basik
		DATE	01/18/10
		ENG.	Robert Alledorand
		DATE	01/18/10
		MFG.	B Velazquez
		DATE	01/18/10
		Q.C.	Robert Alledorand
		DATE	01/18/10
NEXT ASSY	USED ON	SALES.	DATE



DFCI SOLUTIONS INC.
425 UNION BOULEVARD.
WEST ISLIP, NEW YORK 11795

TITLE		ST-1200 LINE STUD, 121J-P4xx-Z3CT	
SIZE	FSCM NO.	DWG. NO.	REV.
A	72794	C121J-P4	D
SCALE: NTS		WEIGHT:	SHEET 1 OF 2

PART NO. (STEEL STUD)	G	U
121J-P425-Z3CT	.250	.100
121J-P430-Z3CT	.300	
121J-P435-Z3CT	.350	.150
121J-P440-Z3CT	.400	.200
121J-P445-Z3CT	.450	.225
121J-P450-Z3CT	.500	.250
121J-P455-Z3CT	.550	.275
121J-P460-Z3CT	.600	.300
121J-P465-Z3CT	.650	.350
121J-P470-Z3CT	.700	
121J-P475-Z3CT	.750	.400
121J-P480-Z3CT	.800	
121J-P485-Z3CT	.850	.500
121J-P490-Z3CT	.900	
121J-P495-Z3CT	.950	.600
121J-P4100-Z3CT	1.000	
121J-P4110-Z3CT	1.100	
121J-P4115-Z3CT	1.150	
121J-P4120-Z3CT	1.200	
121J-P4130-Z3CT	1.300	
121J-P4140-Z3CT	1.400	

REVISIONS			
SYS	DESCRIPTION	DATE	APPROV
D	PER ECN 1168	01/15/10	F.B.

NOTES:

- FINISH
ZINC PLATE PER ASTM-B-633, TYPE III, SC 2, CREAR TRIVALENT CHROMATE WITH SEALER. (RoHS COMPLIANT) FINISH SUFFIX: -Z3CT.

THE ABOVE MENTIONED FINISH WILL BE SUPPLIED AS THE STANDARD FINISHED AS FOLLOW:
ZINC PLATE PER ASTM-B-633, TYPE III, SC 2, CLEAR CHROMATE, FINISH SUFFIX -Z3C.
- HEAT TREATMENT:
STEEL STUD ONLY: ROCKWELL C27-33.
- FOR PART NO. OF STUD MADE FROM ST. STEEL, REMOVE SUFFIX -Z3CT FROM P/N AND ADD "-SS" EXAMPLE 121J-P425-SS.
- FOR THE APPLICATION OF ALTERNATIVE FINISHES, REMOVE SUFFIX -Z3CT FROM THE PART NO. AND ADD THE REQUIRED FINISH TO THE PART NO. SUFFIX.

"EXAMPLE FOR BLACK ZINC TRIVALENT CHROMATE FINISH, THE PART NO IS 121J-P425-Z3BT.
- PLEASE VISIT WWW.DFCIS.COM/C121J-P4 FOR A LIST OF AVAILABLE FINISHES.

MATERIAL: PER A.I.S.I 10B21, 8620 STEEL OR TYPE 303 ST. STEEL

HEAT TREAT: PER NOTE 2

FINISH: PER NOTE 1

THE FASTENER PARTS SHOWN IN THIS PRINT ARE PROPRIETARY ARTICLES TO WHICH DFCI SOLUTIONS INC., RETAINS THE EXCLUSIVE RIGHTS OF MANUFACTURE, USE AND SALE. THE PRINT OR DRAWING IS SUBMITTED IN CONFIDENCE AND DOES NOT CONVEY A LICENSE OR PERMISSION TO MANUFACTURE THE FASTENER OR FASTENER PARTS.

(C) COPYRIGHT 2009, DFCI SOLUTIONS INC. ALL RIGHTS RESERVED.

TOLERANCES ON DIMENSIONS UNLESS OTHERWISE SPECIFIED

X" = ±2" .XX = ±.015
X/X = ±1/32 .XXX = ±.010

MACHINE FINISH = .125

PART NO.	SEE PAGE 2 OF 2	DRN	W. Zhindon	DATE	01/13/10
		CHK.	F Basile	DATE	01/18/10
		ENG.	Robert Altdorff	DATE	01/18/10
		MFG.	B Velazquez	DATE	01/18/10
		Q.C.	Robert Altdorff	DATE	01/18/10
NEXT ASSY	USED ON	SALES.		DATE	



DFCI SOLUTIONS INC.
425 UNION BOULEVARD.
WEST ISLIP, NEW YORK 11795

TITLE		ST-1200 LINE STUD, 121J-P4xx-Z3CT		
SIZE	FSCM NO	DWG. NO.	REV.	
A	72794	C121J-P4	D	
SCALE: NTS		WEIGHT:	SHEET 2 OF 2	