

UNCONTROLLED

C1224-1030-1 REV. **A**

REVISIONS			
SYM	DESCRIPTION	DATE	APPROV
A	INITIAL RELEASE PER ECN 845	8-19-09	<i>FB</i>

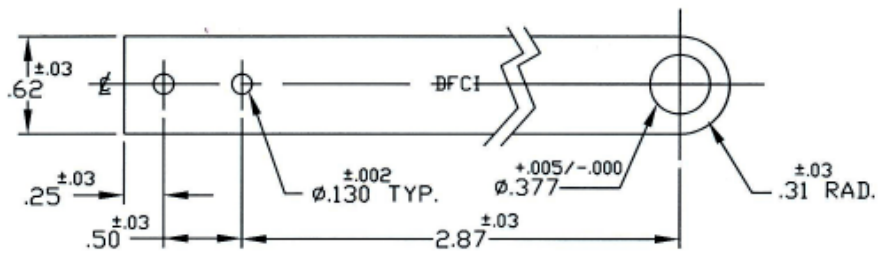

DIM'S AT FLAT

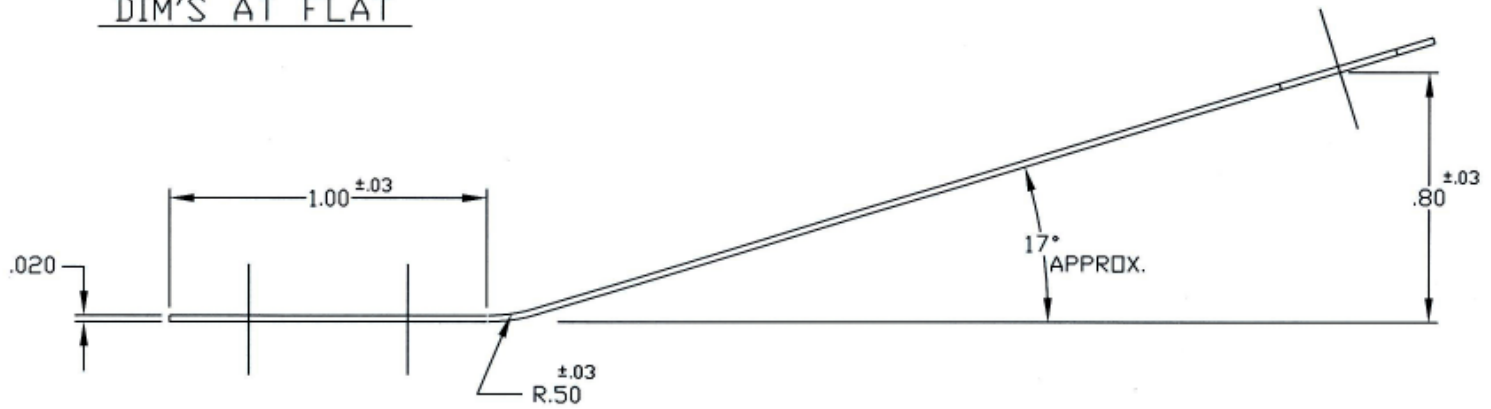

SCALED 2:1

PART NO.
1224-1030-1-SS

MAT'L .020 THK. TYPE 302 ST. STEEL, SPRING TEMPER.		TOLERANCES ON DIMENSIONS UNLESS OTHERWISE SPECIFIED X = ±2' .XX = ±.015 X/X = ±1/32 .XXX = ±.010 MACHINE FINISH .125/		DFCI SOLUTIONS INC. 425 UNION BOULEVARD WEST ISLIP, NEW YORK 11795	
HEAT TREAT NONE.		PART NO. DRN <i>S. Francis</i> DATE 8-19-09 CHK <i>F. Basile</i> DATE 8-20-09 ENG <i>B. Kibbler</i> DATE 8/20/09 MFD <i>Bull</i> DATE 8-20-09		SIZE A FSCM NO 72794 DWG. NO. C1224-1030-1 REV. A	
FINISH CLEAN & FREE OF BURRS.		NEXT ASSY USED ON SALES <i>B. Kibbler</i> DATE 8/20/09		SCALE NTS WT. SHEET 1 OF 1	
<small>THE FASTENER PARTS SHOWN IN THIS PRINT ARE PROPRIETARY ARTICLES TO WHICH DFCI SOLUTIONS INC. RETAINS THE EXCLUSIVE RIGHTS OF MANUFACTURE, USE AND SALE. THE PRINT OR DRAWING IS SUBMITTED IN CONFIDENCE AND DOES NOT CONVEY A LICENSE OR PERMISSION TO MANUFACTURE THE FASTENER OR FASTENER PARTS. © COPYRIGHT 2003, DFCI SOLUTIONS INC. ALL RIGHTS RESERVED.</small>					

DATE: 07/01/06 FORM: DRAWING

The parts shown in this print are proprietary articles to which DFCI Solutions, Inc. retains the exclusive rights of manufacture, use and sale. The print or drawing is submitted in confidence and does not convey a license or permission to manufacture the parts. Copyright © 2009 by DFCI Solutions, Inc. All rights reserved.