

UNCONTROLLED

C1224-721 REV. *B*

REVISIONS			
SYM	DESCRIPTION	DATE	APPROV
B	CHNG FINISH PER ECN 1140	4-15-09	<i>FB</i>

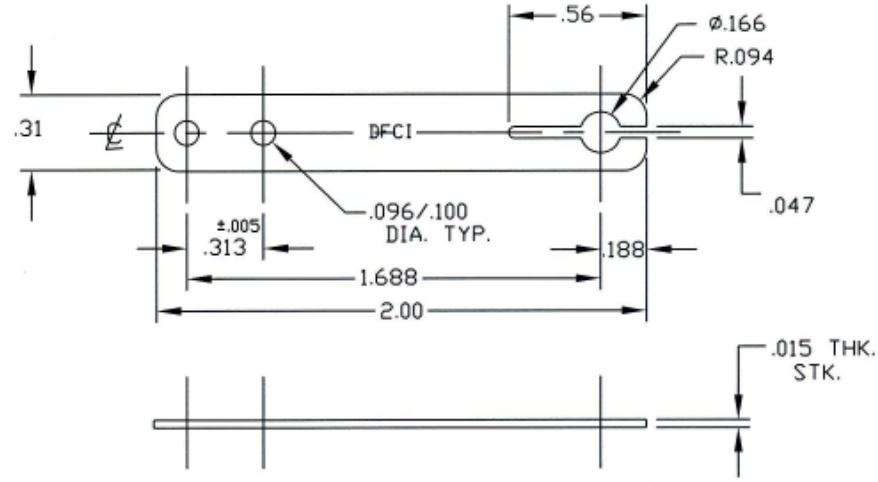

BLANK FORM

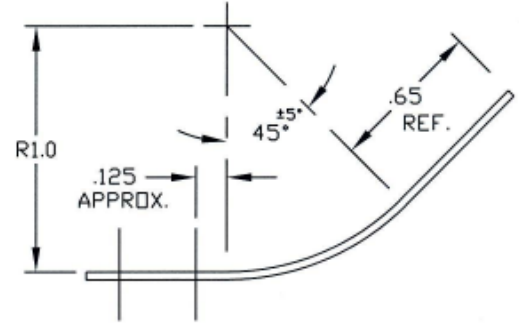

FINISH FORM

PART NO.	MATERIAL	FINISH	WEIGHT (LBS.)
1224-721-Z3CT	PHOSPHOR BRONZE, SPRING TEMPER.	ZINC PLATE PER ASTM-B-633, TYPE III, SC 2, CLEAR TRIVALENT CHROMATE, W/SEALER.	.0031
1224-721-SS	TYPE 302, ST, STEEL SPRING TEMPER.	NATURAL	

MAT'L AS NOTED.		TOLERANCES ON DIMENSIONS UNLESS OTHERWISE SPECIFIED X = ±1/2" .XX = ±.010 X/X = ±1/32 .XXX = ±.005 MACHINE FINISH .125		DFCI SOLUTIONS INC. 425 UNION BOULEVARD WEST ISLIP, NEW YORK 11795	
HEAT TREAT NONE.		PART NO.	DRN S. Franki	DATE 11-24-04	ST-1200 LINE EJECT BLADE, 1224-721-Z3CT.
FINISH AS NOTED.			CHK F. Basile	DATE 4-21-09	
			ENG B. Hilbert	DATE 4-21-09	
			MEG B. Hilbert	DATE 4-21-09	
THE FASTENER PARTS SHOWN IN THIS PRINT ARE PROPRIETARY ARTICLES TO WHICH DFCI SOLUTIONS INC. RETAINS THE EXCLUSIVE RIGHTS OF MANUFACTURE, USE AND SALE. THE PRINT OR DRAWING IS SUBMITTED IN CONFIDENCE AND DOES NOT CONVEY A LICENSE OR PERMISSION TO MANUFACTURE THE FASTENER OR FASTENER PARTS.		NEXT ASSY	USED ON	DATE	SIZE A
DATE: 07/01/06 FORM: DRAWING		APPLICATION BLOCK SALES		DATE 4-21-09	FSCM NO 72794
					DWG. NO. C1224-721
					REV. B
					SCALE NTS WT.
					SHEET 1 OF 1