

UNCONTROLLED

C122J-4-241809 REV. C

| REVISIONS | | | |
|-----------|----------------------------|---------|-----------|
| SYM | DESCRIPTION | DATE | APPROV |
| C | DELETE STEEL STUD ECN 1059 | 9-26-07 | R. OLESBY |

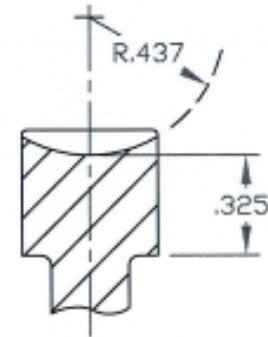
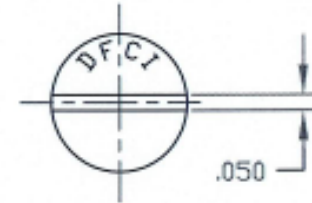
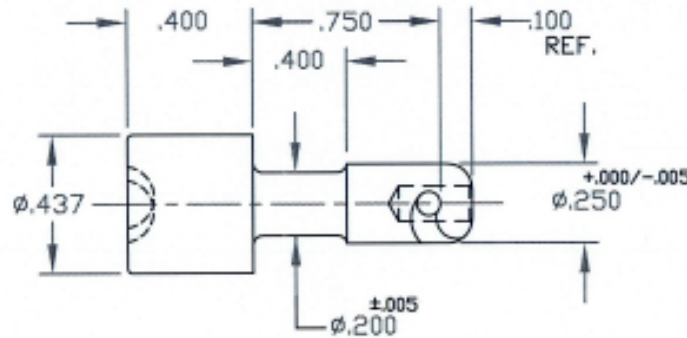
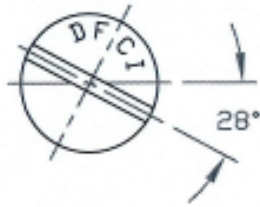

SLOTTING DETAIL

STUD PART NO.
122J-475-241809

| | | | | | | | |
|---------------------------------|--|----------------------------------|-----------------------------|---|-------------------|----------------------------|-----------|
| MATERIAL TYPE 303 ST. STEEL. | TOLERANCES ON DIMENSIONS UNLESS OTHERWISE SPECIFIED | | | DFCI SOLUTIONS INC. 425 UNION BOULEVARD WEST ISLIP, NEW YORK 11795 | | | |
| | $X^* = \pm 2^*$.XX = ±.015 $X/X = \pm 1/32$.XXX = ±.010 MACHINE FINISH 125T | | | | | | |
| HEAT TREAT NONE. | PART NO. | DRN S. F. <i>S. F. Franks</i> | DATE 5-9-03 | TITLE ST-1200 LINE STUD, 122J-475-241809 | | | |
| FINISH NATURAL. | | CHK J. <i>J. Boas</i> | DATE 10-30-07 | | | | |
| | <small>THE FASTENER PARTS SHOWN IN THIS PRINT ARE PROPRIETARY ARTICLES TO WHICH DFCI SOLUTIONS, INC. RETAINS THE EXCLUSIVE RIGHTS OF MANUFACTURE, USE AND SALE. THE PRINT OR DRAWING IS SUBMITTED IN CONFIDENCE AND DOES NOT CONVEY A LICENSE OR PERMISSION TO MANUFACTURE THE PARTS OR PARTS THEREOF.</small> <small>© COPYRIGHT 2003, DFCI SOLUTIONS, INC. ALL RIGHTS RESERVED.</small> | | ENG R. <i>R. Olsen</i> | DATE 10/3/07 | SIZE A | | |
| NEXT ASSY | | USED ON | MFG B. <i>B. Kildner</i> | DATE 10-30-07 | FSCM NO. 72794 | DWG. NO. C122J-4-241809 | REV. C |
| APPLICATION BLOCK | | SALES | DATE 10/3/07 | SCALE NTS | WT. | SHEET 1 OF 1 | |

DATE: 07/01/06 FORM: DRAWING