

UNCONTROLLED

REVISIONS			
SYM	DESCRIPTION	DATE	APPROV
A	INITIAL RELEASE PER ECN 845	5-21-09	<i>ZB</i>

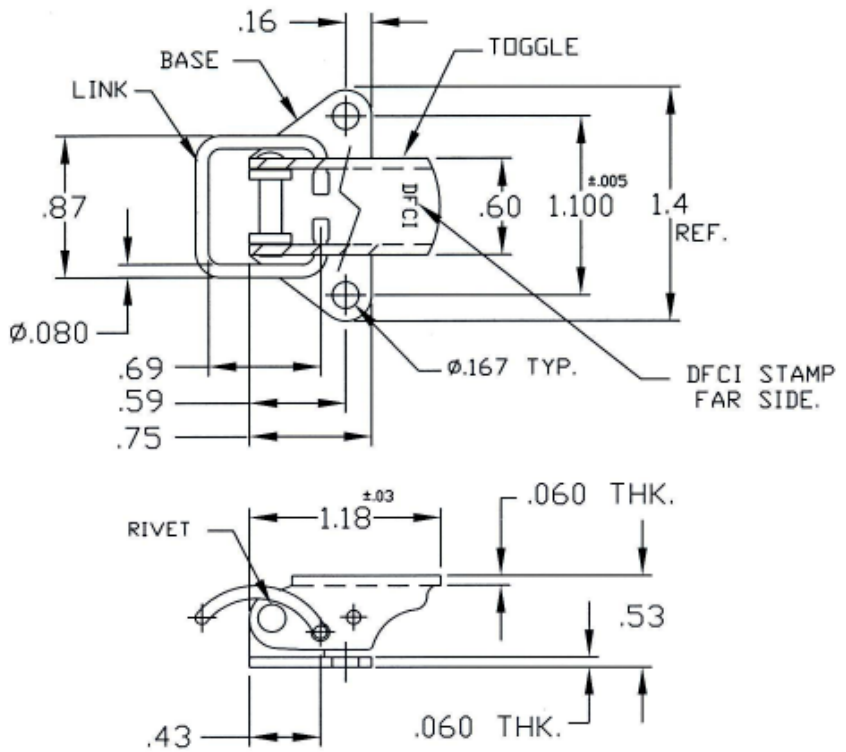

FOR PART NO. REFER TO SHEET 2 of 2.

MAT'L AS NOTED.	TOLERANCES ON DIMENSIONS UNLESS OTHERWISE SPECIFIED		DFCI SOLUTIONS INC.		
	X = ±2* .XX = ±.015 X/X = ±1/32 .XXX = ±.010		425 UNION BOULEVARD WEST ISLIP, NEW YORK 11795		
HEAT TREAT NONE.	PART NO.	DRN <i>S. F. [Signature]</i>	DATE 5-21-09	TITLE 7800 TOGGLE LATCH ASSY. 7883-2-Z3CT.	
FINISH PER NOTE 1.		CHK <i>F. [Signature]</i>	DATE 5-22-09		
THE FASTENER PARTS SHOWN IN THIS PRINT ARE PROPRIETARY ARTICLES TO WHICH DFCI SOLUTIONS INC. RETAINS THE EXCLUSIVE RIGHTS OF MANUFACTURE, USE AND SALE. THE PRINT OR DRAWING IS SUBMITTED IN CONFIDENCE AND DOES NOT CONVEY A LICENSE OR PERMISSION TO MANUFACTURE THE FASTENER OR FASTENER PARTS.		ENG <i>[Signature]</i>	DATE 5-22-09	SIZE A	FSCM NO 72794
DATE: 07/01/06 FORM: DRAWING		MFG <i>[Signature]</i>	DATE 5-22-09	DWG. NO. C7883-2	REV. A
APPLICATION BLOCK		SALES <i>[Signature]</i>	DATE 5-22-09	SCALE NTS	WT.
				SHEET 1 OF 2	

UNCONTROLLED

REVISIONS			
SYM	DESCRIPTION	DATE	APPROV
A	INITIAL RELEASE PER ECN 845	5-21-09	ZB

NOTES:

- FINISH ON BASE AND LEVER:  
ZINC PLATE PER ASTM-B-633, TYPE III, SC 2, CLEAR TRIVALENT CHROMATE WITH SEALER. (RoHS COMPLIANT) FINISH SUFFIX: -Z3CT  
THE ABOVE MENTIONED FINISH WILL BE SUPPLIED AS THE STANDARD FINISH, UPON DEPLETION OF EXISTING STOCK WHICH ARE FINISHED AS FOLLOWS: ZINC PLATE PER ASTM-B-633, TYPE II, SC 2, YELLOW CHROMATE. FINISH SUFFIX -Z3Y.  
THE LINK MADE OF STAINLESS STEEL HAVE NO FINISH.
- FOR THE APPLICATION OF ALTERNATIVE FINISHES, REMOVE SUFFIX -Z3CT FROM THE PART NO. AND ADD THE REQUIRED FINISH TO THE PART NO. SUFFIX. \*EXAMPLE FOR BLACK ZINC TRIVALENT CHROMATE FINISH, THE PART NO. IS 7883-2-Z3BT.
- PLEASE VISIT WWW.DFCIS.COM/C7883-2 FOR A LIST OF AVAILABLE FINISHES.

PART NO.	MATERIAL		
	BASE & LEVER	LINK	RIVET
7883-2-Z3CT	PER A.I.S.I 1008/1010 STEEL.	17-7 ST. STEEL	300 SERIES STAINLESS STEEL.
7883-2-SS	300 SERIES STAINLESS STEEL.		

MAT'L AS NOTED.	TOLERANCES ON DIMENSIONS UNLESS OTHERWISE SPECIFIED X = ±2" .XX = ±.015 X/X = ±1/32 .XXX = ±.010 MACHINE FINISH .125		DFCI SOLUTIONS INC. 425 UNION BOULEVARD WEST ISLIP, NEW YORK 11795	
HEAT TREAT NONE.	PART NO.	DRN S. FRAWLEY	DATE 5-21-09	TITLE L-7800 TOGGLE LATCH ASSY. 7883-2-Z3CT.
FINISH PER NOTE 1.		CHK Z. Basile	DATE 5-22-09	
<small>THE FASTENER PARTS SHOWN IN THIS PRINT ARE PROPRIETARY ARTICLES TO WHICH DFCI SOLUTIONS INC. RETAINS THE EXCLUSIVE RIGHTS OF MANUFACTURE, USE AND SALE. THE PRINT OR DRAWING IS SUBMITTED IN CONFIDENCE AND DOES NOT CONVEY A LICENSE OR PERMISSION TO MANUFACTURE THE FASTENER OR FASTENER PARTS.</small> <small>© COPYRIGHT 2003, DFCI SOLUTIONS INC. ALL RIGHTS RESERVED.</small>	NEXT ASSY	USED ON	DATE 5/22/09	SIZE A
	APPLICATION BLOCK	SALES	DATE	FSCM NO 72794
DATE: 07/01/06 FORM: DRAWING			DWG. NO. C7883-2	REV. A
			SCALE NTS	WT. SHEET 2 OF 2